



SPECIAL FEATURES PLS

- For natural ventilation, smoke and heat exhausting and ferralux® NRWG (EN12101-2)
- Powerful heavy duty drives for loads up to 5000 N
- Robust corrosion-resistant design in aluminium housing (D = 50 mm), optionally in RAL colors
- Easy installation due to adjustable clamp ring (Rear suspension on request)
- Spindle is ball beared with end position dampening and gentle soft-start and soft-stop mode
- Stainless steel spindle tube
- Programmable parameters of Intelligent Control Electronics S12
 - Synchronised multi-operation and sequence control without add. devices
 - Electronic soft-start, soft-close and soft-stop at end of stroke control
 - Stroke, force, speed
 - Rebate control
- With GoreTex membrane
- Suitable for operation with M-COM for the automatic configuration of synchronised run of multi drive systems and sequence control

For this product series, a Type III Environmental Product Declaration (EPD) was issued according to ISO 14025 and EN 15804.

The LCA results of the different product types are listed at the end of this product catalogue.

The EPD documents can be viewed or downloaded from our homepage www.aumueller-gmbh.de.

FACADE

Bottom-hung

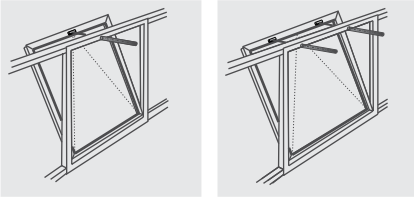

Top-hung

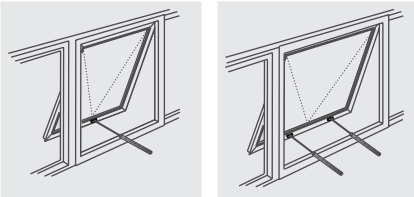

Side-hung

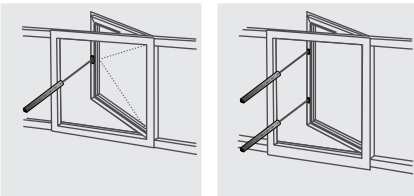

ROOF

Bottom-hung

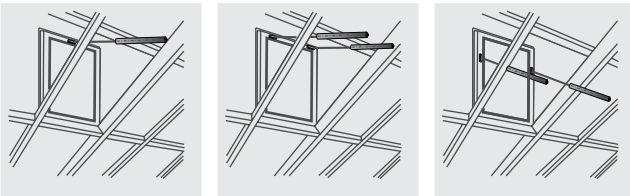

Top-hung

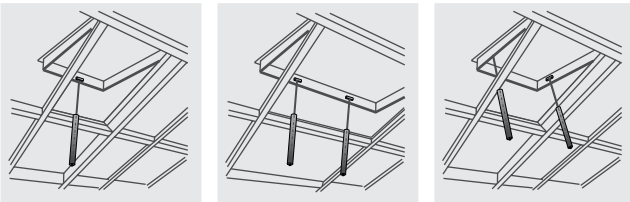

Skylight

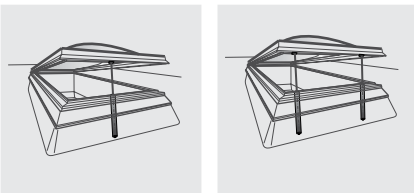

Glass pyramid

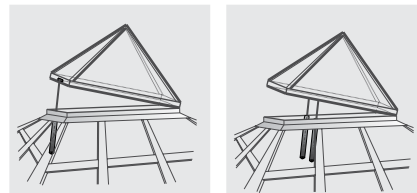

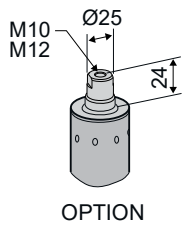

■ Application: natural ventilation, RWA, ferralux®-NRWG

■ Internal Intelligent Control Electronics S12

Options

■ Programmable synchronised run (max. 4 drives) and special functions

■ M-COM for automatic synchronised run of multi drive systems and automatic sequence control with locking drives (S3 / S12)

■ Spindle tube end with interior thread for clevis

■ Eyebolt and clevis for rear suspension

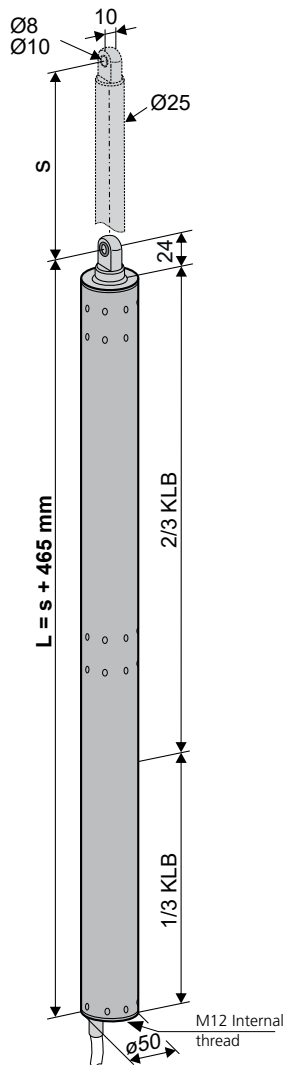

TECHNICAL DATA

U_N Rated voltage 24V DC (19 V ... 28 V)

I_N Rated current 3,0 A

I_A Cut-off current 4,0 A

P_N Rated power 72 W

DC Duty cycle 5 cycles (ED 30 % - ON: 3 min./OFF: 7 min.)

Protection rating IP 54

Ambient temperature range -5 °C ... +60 °C

F_Z Pulling force max. 1500 N

F_A Pushing force max.

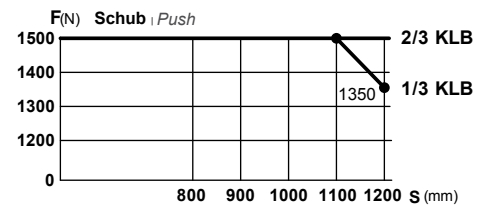

F_H Pullout force 25000 N (fastening depended)

Spindle tube stainless steel

Connecting cable non-halogen, grey 3 x 1,0 mm², ~ 3 m

v Speed 16,0 mm/s 16,0 mm/s

s Stroke 300 – 1200 mm

L Length s + 465 mm
see order data

Sound pressure level ≤ 70 dB (A)

OPTION

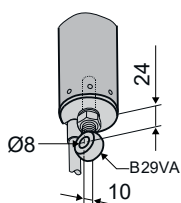

ORDER DATA						
s [mm]	L [mm]	Version	Finish	PU/pcs.	Part.-No.	
300	765	PLS15 300 S12	E6/C-0	1	576830	
400	865	PLS15 400 S12	E6/C-0	1	576840	
500	965	PLS15 500 S12	E6/C-0	1	576850	
600	1065	PLS15 600 S12	E6/C-0	1	576860	
750	1215	PLS15 750 S12	E6/C-0	1	576875	
1000	1465	PLS15 1000 S12	E6/C-0	1	576800	
1200	1665	PLS15 1200 S12	E6/C-0	1	576812	

OPTIONS						
Special model				PU/pcs.	Part.-No.	
Front Fixing						
Spindle tube end with interior thread M10				1	515062	
Spindle tube end with interior thread M12				1	515063	
Drive housing painted/powder coated in other RAL colours						
Lump sum for coating					516030	
Specify at order stage:				1 – 20	516004	
				21 – 50	516004	
				51 – 100	516004	
				from 101	516004	
Extra length connecting cable:						
5 m – non-halogen, grey – 3 x 1,0 mm ²					501037	
10 m – non-halogen, grey – 3 x 1,0 mm ²					501039	
Accessories for front / rear suspension						
B29VA Eyebolt M12x40mm, Ø8 mm, stainless steel				1	105430	
B28ST Clevis M10x20 mm, galvanized, thread M10x50 mm				1	105520	
Microprocessor programming S12						
Electronic stroke reduction 24V S12				1	524190	
Programming drives 24V / 230V S12				1	524180	
Other lengths available on request						
Optional accessories				PU/pcs.	Part.-No.	
M-COM Configuration module for synchronised multi-drive systems				1	524177	

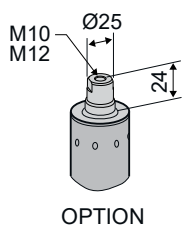

- Application: natural ventilation, RWA, ferralux®-NRWG
- Internal Intelligent Control Electronics S12

Options

- Programmable synchronised run (max. 4 drives) and special functions
- M-COM for automatic synchronised run of multi drive systems and automatic sequence control with locking drives (S3 / S12)
- Spindle tube end with interior thread for clevis
- Eyebolt and clevis for rear suspension

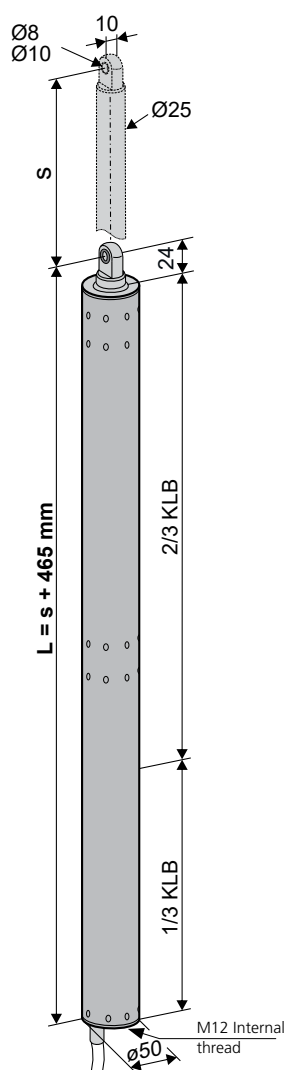

TECHNICAL DATA

U_N	Rated voltage	24V DC (19V ... 28V)
I_N	Rated current	3,8 A
I_A	Cut-off current	5,0 A
P_N	Rated power	91 W
DC	Duty cycle	5 cycles (ED 30 % - ON: 3 min./OFF: 7 min.)
	Protection rating	IP 54
	Ambient temperature range	-5 °C ... +60 °C
F_Z	Pulling force max.	3000 N
F_A	Pushing force max.	

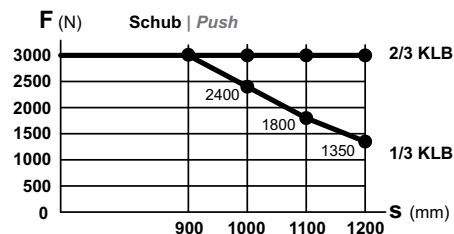

F_H	Pullout force	25000 N (fastening depended)
	Spindle tube	stainless steel
	Connecting cable	non-halogen, grey 3 x 1,0 mm ² , ~ 3 m
v	Speed	7,8 mm/s
s	Stroke	300 – 1200 mm
L	Length	s + 465 mm see order data
	Sound pressure level	≤ 70 dB (A)

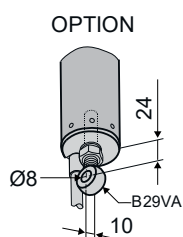

ORDER DATA						
s [mm]	L [mm]	Version	Finish	PU/pcs.	Part.-No.	
300	765	PLS30 300 S12	E6/C-0	1	577530	
400	865	PLS30 400 S12	E6/C-0	1	577540	
500	965	PLS30 500 S12	E6/C-0	1	577550	
600	1065	PLS30 600 S12	E6/C-0	1	577560	
750	1215	PLS30 750 S12	E6/C-0	1	577575	
1000	1465	PLS30 1000 S12	E6/C-0	1	577500	
1200	1665	PLS30 1200 S12	E6/C-0	1	577512	

OPTIONS						
Special model				PU/pcs.	Part.-No.	
Front Fixing						
Spindle tube end with interior thread M10				1	515062	
Spindle tube end with interior thread M12				1	515063	
Drive housing painted/powder coated in other RAL colours						
Lump sum for coating					516030	
Specify at order stage:				1 – 20	516004	
				21 – 50	516004	
				51 – 100	516004	
				from 101	516004	
Extra length connecting cable:						
5 m – non-halogen, grey – 3 x 1,0 mm ²					501037	
10 m – non-halogen, grey – 3 x 1,0 mm ²					501039	
Accessories for front / rear suspension						
B29VA Eyebolt M12x40mm, Ø8 mm, stainless steel				1	105430	
B28ST Clevis M10x20 mm, galvanized, thread M10x50 mm				1	105520	
Microprocessor programming S12						
Electronic stroke reduction 24V S12				1	524190	
Programming drives 24V / 230V S12				1	524180	
Other lengths available on request						
Optional accessories				PU/pcs.	Part.-No.	
M-COM Configuration module for synchronised multi-drive systems				1	524177	

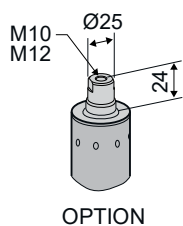

- Application: natural ventilation, RWA
- Internal Intelligent Control Electronics S12

Options

- Programmable synchronised run (max. 4 drives) and special functions
- M-COM for automatic synchronised run of multi drive systems and automatic sequence control with locking drives (S3 / S12)
- Spindle tube end with interior thread for clevis
- Eyebolt and clevis for rear suspension

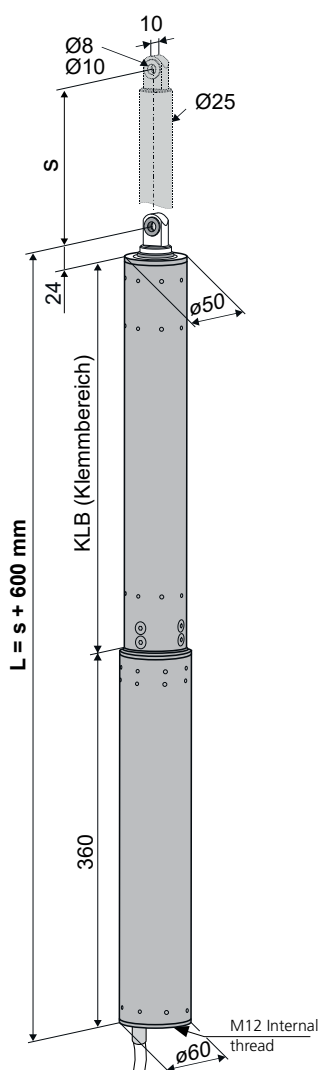

TECHNICAL DATA

U_N	Rated voltage	24V DC (19V ... 28V)
I_N	Rated current	3,0 A
I_A	Cut-off current	4,2 A
P_N	Rated power	72 W
DC	Duty cycle	5 cycles (ED 30 % - ON: 3 min./OFF: 7 min.)
	Protection rating	IP 54
	Ambient temperature range	-5 °C ... +60 °C
F_Z	Pulling force max.	5000 N
F_A	Pushing force max.	

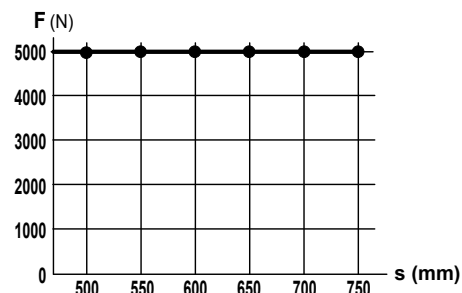

F_H	Pullout force	25000 N (fastening depended)
	Spindle tube	stainless steel
	Connecting cable	non-halogen, grey 3 x 1,0 mm ² , ~ 3 m
v	Speed	\swarrow 4,0 mm/s \searrow 4,0 mm/s
s	Stroke	200 – 750 mm
L	Length	s + 600 mm see order data
	Sound pressure level	≤ 70 dB (A)

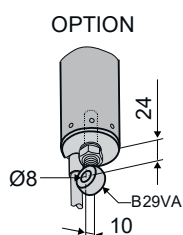

ORDER DATA

s [mm]	L [mm]	Version	Finish	PU/pcs.	Part.-No.			
200	800	PLS50 200 S12	E6/C-0	1	577620			
300	900	PLS50 300 S12	E6/C-0	1	577630			
400	1000	PLS50 400 S12	E6/C-0	1	577640			
500	1100	PLS50 500 S12	E6/C-0	1	577650			
600	1200	PLS50 600 S12	E6/C-0	1	577660			
750	1350	PLS50 750 S12	E6/C-0	1	577675			

OPTIONS

Special model	PU/pcs.	Part.-No.			
Front Fixing					
Spindle tube end with interior thread M10	1	515062			
Spindle tube end with interior thread M12	1	515063			
Drive housing painted/powder coated in other RAL colours					
Lump sum for coating		516030			
Specify at order stage:	1 – 20	516004			
	21 – 50	516004			
	51 – 100	516004			
	from 101	516004			
Extra length connecting cable:					
5 m – non-halogen, grey – 3 x 1,0 mm ²		501037			
10 m – non-halogen, grey – 3 x 1,0 mm ²		501039			
Accessories for front / rear suspension					
B29VA Eyebolt M12x40mm, Ø8 mm, stainless steel	1	105430			
B28ST Clevis M10x20 mm, galvanized, thread M10x50 mm	1	105520			
Microprocessor programming S12					
Electronic stroke reduction 24V S12	1	524190			
Programming drives 24V / 230V S12	1	524180			
Other lengths available on request					
Optional accessories	PU/pcs.	Part.-No.			
M-COM Configuration module for synchronised multi-drive systems	1	524177			

OVERVIEW OF BRACKETS												
Typical applications					1	2	3	4	5	6	7	
Frame bracket					K70	K82-1	K82-1	K121	K127-1	K121-1	K121-1	
Mounting aid												
Bracket accessories					clamping ring B6 (50 mm-G1/8)							
Casement bracket					F10.8S, F10.10		F28-1	F28	F10.11	F36	F30	
Special application					Wictec 50, Wing 105 D	AWS 57RO, Wing 105D	Heroal 085D	Heroal 085D	roof window	Schüco AWS 57RO	Wicona Wictec 50	
Space requirement		min.	[mm]		120	50	50	35	35	50	50	
Window material		Alu			●	●	●	●	●	●	●	
		Wood			●	●						
		PVC			●	●						
Type of window and mounting	Bottom hung	inward	HSK	FM								
				RM								
			NSK	FM								
				RM								
		outward	HSK	RM		●						
				PR								
			NSK	RM								
				PR								
	Top hung	inward	HSK	FM								
				RM								
			NSK	FM								
				RM								
		outward	HSK	RM		●						
				PR								
			NSK	RM								
				PR								
	Side hung	inward	HSK	FM								
				RM								
			NSK	FM								
				RM								
	Roof	outward	HSK	RM	●	●	●					
				PR								
			NSK	RM				●	●	●	●	
				PR								
	Sky-light	outward	HSK	RM	●	●						
			NSK	RM								
FAB(*1		Solo	[mm]		450 – 1300							
		Sync2	[mm]		1200 – 2500							
FAH(*1		Solo	[mm]		450 – 1500							
		Sync2	[mm]		450 – 2500							

LEGEND

● suitable ■ not recommended

(*1) Sample value of the casement dimensions. The actual casement dimensions depend on the stroke and the position of the drives to the hinges. The values of FAB/FAH are to be used analogue for side hung windows.

TYPICAL APPLICATIONS

1 RM, HSK, roof

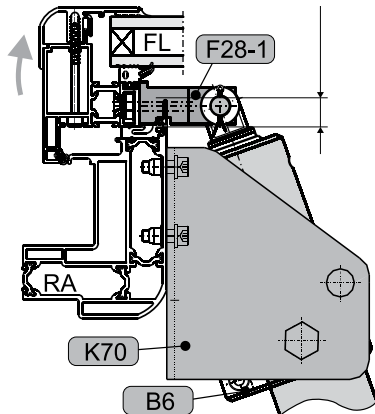

View on aluminium window

1 RM, HSK, op-hung outward opening

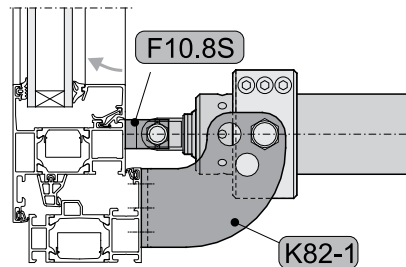

View on steel window

2 RM, HSK, roof

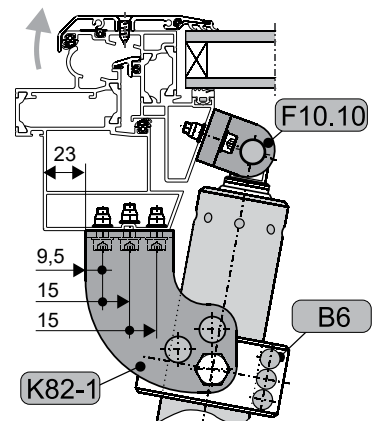

View on aluminium window

3 RM, HSK, roof

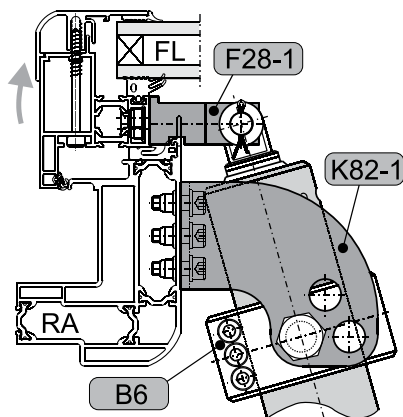

View on aluminium window

4 RM, NSK, roof

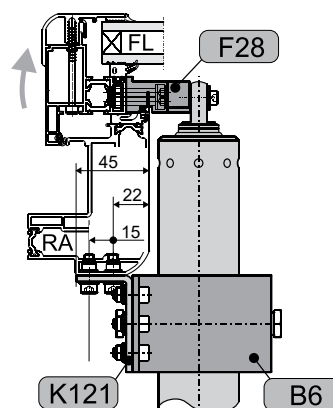

View on aluminium window

5 RM, NSK, roof

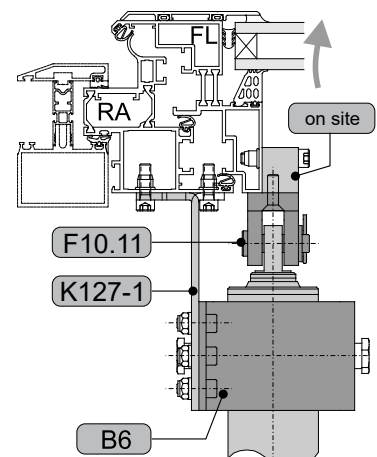

View on aluminium window

6 RM, NSK, roof

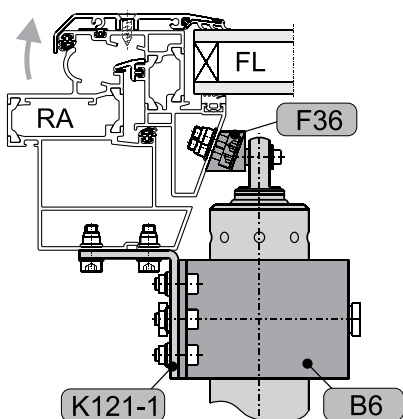

View on aluminium window

7 RM, NSK, roof

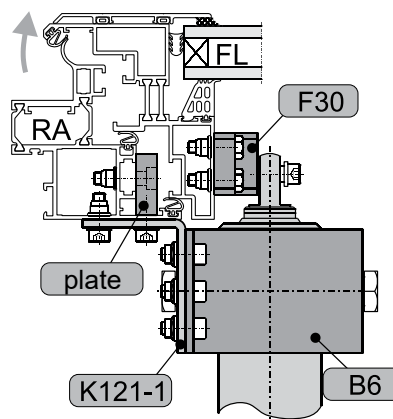

View on aluminium window

CASEMENT BRACKETS

F10.8S

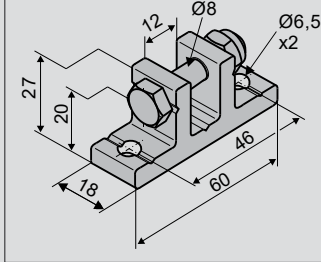

Application

Surface mounting on the **main closing edge** of casement profiles of outward opening windows, for drives with **front or rear suspension** with bore **Ø8 mm**

Part.-No. 151105

Material/Finish

aluminium

Feature/Equipment

1x nut M8,
1x screw M8x35

Load

max. 3000 N

F10.10

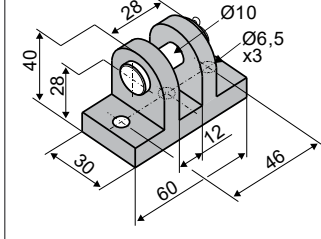

Application

Surface mounting on the **main closing edge** of the casement profiles of outward opening windows, for drives with **front or rear suspension** with bore **Ø10 mm**

Part.-No. 151201

Material/Finish

aluminium, stainless steel

Feature/Equipment

1x bolt Ø10 mm,
washer, split pin

Load

max. 5000 N

F10.11

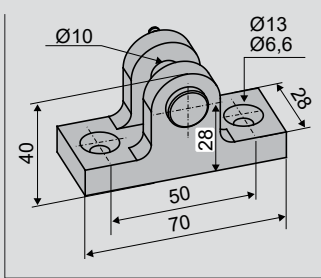

Application

Surface mounting on the **side closing edge** of casement/window frame profiles of in-/outward opening windows or on skylights, for drives with **front or rear suspension** with bore **Ø10 mm**, mounting holes aligned with central axis of drive

Part.-No. 151202

Material/Finish

aluminium, stainless steel

Feature/Equipment

1x bolt Ø10 mm,
washer,
cotter pin

Load

max. 5000 N

F40

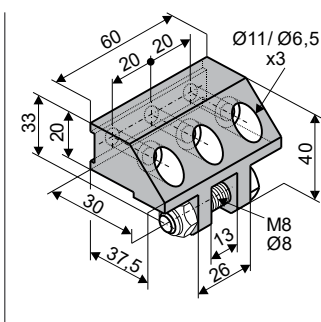

Application

Surface mounting on the **main closing edge** of the casement profiles of outward opening roof windows, for drives with **front or rear suspension** with bore **Ø8 mm**

Part.-No. 155172

Material/Finish

aluminium

Feature/Equipment

1x screw M8x35,
nut M8

Load

max. 3000 N

Optional accessories

B2 Base plate F39 / F40

Part.-No. 155173

FRAME BRACKETS

K70

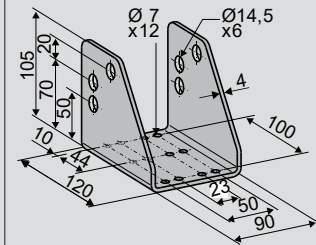

Application

Surface mounting on the main closing edge of window frame profiles or on the mullion/transom of outward opening (roof-)windows, for swivelling suspension of drives
PLS with B6

Part.-No. 155002

Material/Finish

steel galvanized

Feature/Equipment
drilled holes Ø14,5 mm

Accessories

B6 clamp ring PLS
(Ø50mm, G1/8)

Part.-No. 576001

K82-1

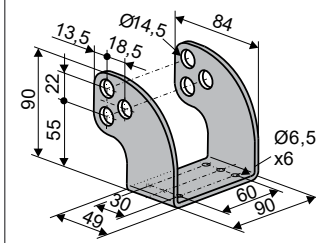

Application

Surface mounting on the main closing edge of window frame profiles or on the mullion/transom of outward opening (roof-)windows, for swivelling suspension of drives
PLS with B6

Part.-No. 151321

Material/Finish

stainless steel

Feature/Equipment
drilled holes Ø14,5 mm

Accessories

B6 clamp ring PLS
(Ø50mm, G1/8)

Part.-No. 576001

OPTIONAL ACCESSORIES

B6

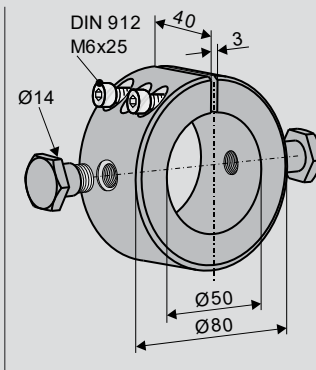

Application

Adjustable clamping of the PLS drive housing, for surface mounting with swivelling suspension on K70, K82-1, K121, K 21-1, K127-1 (preferably on outward opening windows.)

Part.-No. 576001

Material/Finish

aluminium (antreated), stainless steel

Feature/Equipment
2x B9 collar screw
Ø14mm, G1/8,
2x cylinder head screw
M6x25

B9

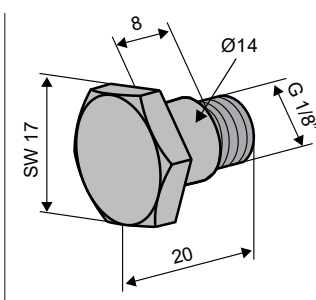

Application

Swivelling suspension of the clamp ring
B6 for PLS
for U-shaped frame brackets with bore Ø14,5 mm

Part.-No. 172900

Material/Finish

stainless steel

Feature/Equipment
Collar Ø14 mm, G1/8"

SPECIFIC APPLICATIONS

SCHÜCO AWS 57RO, WICONA WICTEC 50, RAICO WING 105D – HSK

F10.8S

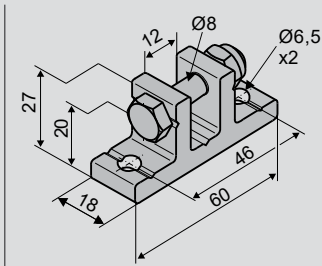

Application

Surface mounting on the **main closing edge** of casement profiles of outward opening windows, for drives with **front or rear suspension** with bore **Ø8 mm**

Part.-No. 151105

Material/Finish
aluminium

Feature/Equipment

1x nut M8,
1x screw M8x35

Load

max. 3000 N

K82-1

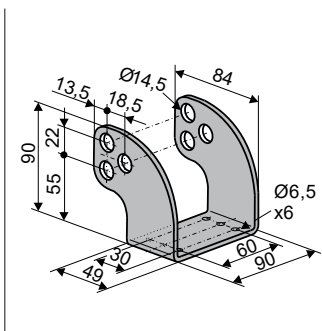

Application

Surface mounting on the **main closing edge** of window frame profiles or on the mullion/transom of outward opening (roof-)windows, for **swivelling suspension** of drives **PLS with B6**

Part.-No. 151321

Material/Finish
stainless steel

Feature/Equipment
drilled holes Ø14,5 mm

Accessories

B6 Clamp ring PLS
(Ø50 mm, G1/8)

Part.-No. 576001

SCHÜCO AWS 57RO – NSK

F36

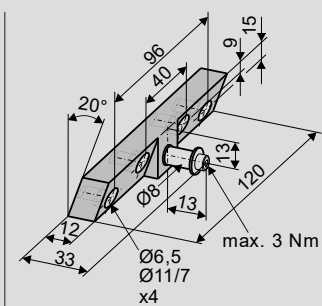

Application

Surface mounting on the **side closing edge** of outward opening casement profiles of roof windows **Schüco AWS 57RO**, for drives with **front suspension** with bore **Ø8 mm**

Part.-No. 155170

Material/Finish
aluminium
(natural anodized),
stainless steel

Feature/Equipment

1x bolt Ø8 mm,
screw M4,
washer A4,3

K121-1

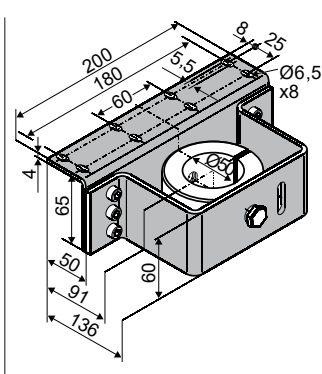

Application

Surface mounting on the **side closing edge** of window frame profiles of outward opening roof windows **Schüco AWS 57RO**, **Wicona Wictec 50**, **Metra** for **swivelling suspension** of drives **PLS with B6**

Part.-No. 155117

Material/Finish
stainless steel

Feature/Equipment
without clamp ring B6

Accessories

B6 Clamp ring PLS
(Ø50 mm, G1/8)

Part.-No. 576001

WICONA WICTEC 50 – NSK					
F30		Application Surface mounting on the side closing edge of the outward opening casement profiles of roof windows Wicona Wictec 50 , for drives with front suspension with bore Ø8 mm	Part.-No. 155160 Material/Finish aluminium (natural anodized), stainless steel Feature/Equipment 1x bolt Ø8 mm, screw M4, washer A4,3		
K121-1		Application Surface mounting on the side closing edge of window frame profiles of outward opening roof windows Schüco AWS 57RO , Wicona Wictec 50 , Metra for swivelling suspension of drives PLS with B6	Part.-No. 155117 Material/Finish stainless steel Feature/Equipment without clamp ring B6		
Accessories					
	B6 Clamp ring PLS (Ø50 mm, G1/8)	Part.-No. 576001			
Roof window – NSK					
F10.11		Application Surface mounting on the side closing edge of casement/window frame profiles of in-/outward opening windows or on skylights, for drives with front or rear suspension with bore Ø10 mm , mounting holes aligned with central axis of drive	Part.-No. 151202 Material/Finish aluminium, stainless steel Feature/Equipment 1x bolt Ø10 mm, washer, cotter pin Load max. 5000 N		
K127-1		Application Surface mounting on the side closing edge of window frame profiles of outward opening roof windows for swivelling suspension of drives PLS with B6	Part.-No. 155118 Material/Finish stainless steel Feature/Equipment without clamp ring B6		
Accessories					
	B6 Clamp ring PLS (Ø50 mm, G1/8)	Part.-No. 576001			

SPECIFIC APPLICATIONS

HEROAL 085 / 180 – HSK

F28-1

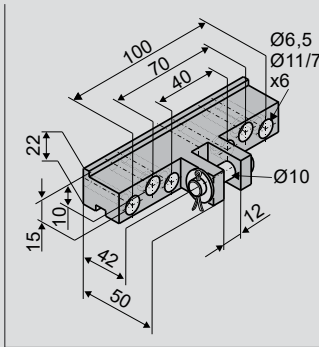

Application

Surface mounting on the **main closing edge** of outward opening casement profiles of roof windows **Heroal 085D**, for drives with **front suspension** with bore **Ø10 mm**

Part.-No. 155154

Material/Finish

aluminium
(natural anodized),
stainless steel

Feature/Equipment

1x bolt Ø10 mm,
screw M5,
washer A5,3
split pin 2x20

K82-1

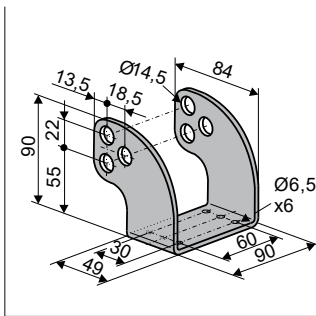

Application

Surface mounting on the **main closing edge** of window frame profiles or on the mullion/transom of outward opening (roof-)windows, for **swivelling suspension** of drives **PLS** with **B6**

Part.-No. 151321

Material/Finish

stainless steel

Feature/Equipment

drilled holes Ø14,5 mm

Accessories

B6 Clamp ring PLS
(Ø50 mm, G1/8)

Part.-No. 576001

HEROAL 085 / 180 – NSK

F28

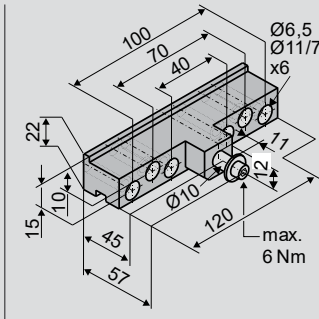

Application

Surface mounting on the **side closing edge** of outward opening casement profiles of roof windows **Heroal 085D**, for drives with **front suspension** with bore **Ø10 mm**

Part.-No. 155155

Material/Finish

aluminium
(natural anodized),
stainless steel

Feature/Equipment

1x bolt Ø10 mm,
screw M5,
washer A5,3

K121

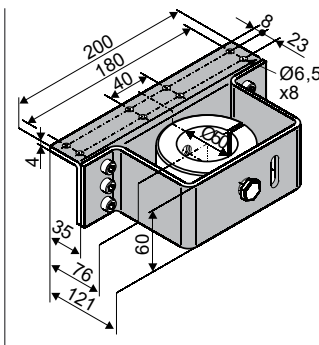

Application

Surface mounting on the **side closing edge** of window frame profiles of outward opening roof windows **Schüco RS 106D**, **Heroal 085D** for **swivelling suspension** of drives **PLS** with **B6**

Part.-No. 155110

Material/Finish

stainless steel

Feature/Equipment



without clamping ring B6

Accessories

B6 Clamp ring PLS
(Ø50 mm, G1/8)

Part.-No. 576001

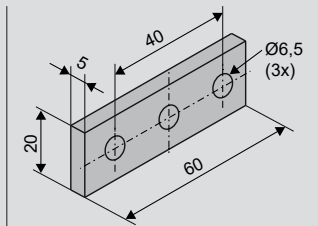
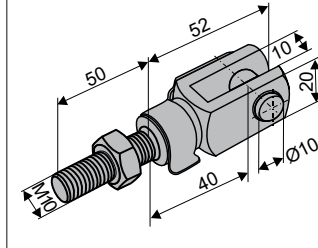
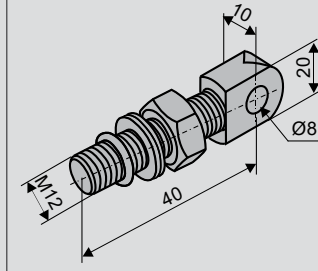
OPTIONAL ACCESSORIES

Base Plate					
B2		Application Support for F39 and F40 as packing plate for mounting on the casement profiles of outward opening roof windows	Part.-No. 155173 Material/Finish aluminium (natural anodized) Feature/Equipment 60 x 20 x 5 mm		
Clevis					
B28ST		Application Clevis for rear or front suspension of spindle drives with M10 thread in the rear base cap or in the spindle tube	Part.-No. 105520 Material/Finish steel galvanized Feature/Equipment Clevis M10 x 50 mm with spring bolt Ø10 mm and thread M10x 50 mm 1x nut M10 + Nordlock-safety-washer + O-ring, max. screw-in depth in the drive 25 mm		
Eyebolt					
B29VA		Application Eyebolt for rear or front suspension of spindle drives with M12 thread in the rear base cap or in the spindle tube	Part.-No. 105430 Material/Finish stainless steel Feature/Equipment M12x 40 (eye Ø8,2 mm), 1x nut M12 + Nordlock-safety-washer + o-ring, minimum depth drive 25 mm		
Main control unit					
M-COM		Application Configuration module for automatic configuration and surveillance of max. 4 opening drives / 2 locking drives version S12 / S3 in synchronised multi-drive systems Rated voltage: 24V DC (19V ... 28V) Current consumption: <12 mA Drive type: S12	Part.-No. 524177 Protection rating IP30 rubber envelope Ambient temperature range 0 °C ... + 70 °C Dimensions 45 x 17 x 6 mm Connecting wires 3 wires 0,5 mm² x 50 mm Feature/Equipment Printed circuit board with components and connection wires to be installed in connection box to be supplied on site		
Special model		PU/pcs.	Part.-No.		
Casement brackets painted / powder coated in other RAL colours					
Lump sum for coating			516030		
Specify at order stage:	1 – 20		516032		
	21 – 50		516032		
	51 – 100		516032		
	from 101		516032		
Frame brackets painted / powder coated in other RAL colours					
Lump sum for coating			516030		
Specify at order stage:	1 – 20		516031		
	21 – 50		516031		
	51 – 100		516031		
	from 101		516031		